

UNSW In-Person Exchange Fact Sheet

About UNSW



Welcome to UNSW Sydney

We are an internationally acclaimed teaching and research powerhouse, offering exchange students a learning experience packed with academic programs, student activities and educational services.

UNSW Sydney is one of Australia's leading research and teaching universities and one of the top 50 universities in the world. We take pride in the broad range and high quality of our teaching programs. Our teaching gains strength and currency from our research activities, strong industry links and our international nature; UNSW has strong regional and global engagement. We have over 59,000 students and offer an extensive range of undergraduate, postgraduate and research programs.

Located in Sydney, Australia's business and technology capital, the University was established in 1949 and is committed to shaping forward thinking, environmentally conscious and socially engaged students who will make a positive impact in the world.

UNSW's campuses are located between Sydney's coastal eastern suburbs and bustling city centre - surrounded by public transport options. There are trains, buses, ferries and light rail options that run from UNSW campuses throughout Sydney. A short bus trip will take you to explore the famous

beaches of Coogee or Bondi, while the new Light Rail network takes you from UNSW's Kensington campus to the central business district and inner city. The main UNSW campus is located at Kensington and our other major campus is UNSW Paddington. Take our [360 virtual campus tour](#), view UNSW Sydney [Bring your difference](#) and [UNSW Campus Tour 2023](#) to see what we have to offer!

COVID-19

UNSW continues to monitor the COVID-19 situation and we recommend you are flexible with your plans.

Course information and selection



Language of instruction

The language of instruction at UNSW is English.

Course load

You are required to enrol in a full-time load at UNSW. The normal full-time load is 18 units of credit per term and 24 units of credit for tailored terms (3 subjects per term or 4 subjects per tailored term). It is not possible to underload or overload.

Course selection

For a list of courses of UNSW courses, term availability, class times and content outlines, view the [UNSW Handbook](#). You can view our [instructions](#) on how to search for courses. When selecting courses, it is important to be flexible. You can also refer to our [Winter Term Course Guide](#) for courses that are expected to run in our Winter Term.

- You must meet any prerequisites for courses. This is assessed at the time of application, and new courses can be submitted for approval post acceptance.
- Check your proposed courses are offered in the term you will be on exchange.
- Make sure you have back up courses in case your preferred courses are not available. Faculties are unlikely to approve timetable clashes. We recommend you submit course approval for all back up courses as early as possible.
- You are required to enrol in a full-time load each term. It is not possible to overload.
- You should discuss your proposed courses (and back up options) with your home university and have these approved by them in advance.
- You are expected to study with UNSW for the entire duration of your study plan, including all exams and assessments.
- Generally undergraduate students are not able to enrol in graduate courses, but there may be some limited options for Law and some Science and Engineering subjects.
- It is generally not possible for graduate students to enrol in undergraduate courses.

[Equitable Learning Services](#)

[Equitable Learning Services](#) provide a range of services to students with disabilities, including note takers, classwork support, assistive technology and exam adjustments.

If you receive educational adjustments at your home university, you need to register with UNSW Equitable Learning Services prior to study commencement to ensure the appropriate services are in place by the time you start at UNSW. You will not be registered automatically.

Support services in Australia may be different to those offered at your home university (for example, adjustments for extra time in exams may be shorter). While at UNSW you will receive the same educational adjustments as local students, and it is best to make enquiries about what services may be available to you before you arrive.

Course restrictions



While most courses are open to exchange students with the required academic background, some courses are restricted or not available to exchange students.

- Exchange students are limited to taking one online course only.
- Courses in the Winter Term are limited and are generally electives, we recommend you are flexible.
- Postgraduate students who are in their first semester and who do not have a transcript with results for their postgraduate studies at time of application should select first year postgraduate courses. Upper-level postgraduate courses will not be approved without a transcript demonstrating you meet any prerequisite courses, and you need to provide your transcript at least 6 weeks before term start date to be able to request enrolment in these courses at UNSW.

Faculty of Law & Justice

- Enrolment is restricted to Law Majors. Coursework is available at undergraduate and postgraduate level
- Juris Doctor courses are open to students enrolled in a Juris Doctor Program at their home institution
- Students are not able to take both LAWS and JURD courses simultaneously
- LLM elective courses are open to Law Exchange students
- Undergraduate and JD law enrolment for Exchange students is capped, and students are encouraged to also look at LLM elective courses

- Core courses are not available to Exchange students
- Course LAWS3331 is not available to Exchange students

Faculty of Arts, Design & Architecture

The Arts & Media, Education, Humanities & Languages, Social Sciences

- Students wishing to take stage 3 ARTS courses must be majoring in the desired field
- Undergraduate students can only enrol in undergraduate courses
- Postgraduate students are not eligible to take undergraduate courses
- INST, GLST, DANC, EDST, MDIA and Music courses are restricted to declared majors

Art & Design

- Courses are held at the Paddington campus, approximately 20 minutes away – a [free shuttle bus service](#) is available
- Priority will be given to students majoring in Art/Design
- Students can take a mix of courses from Paddington and Kensington (main) campus, as long as they are aware of the travel involved

Built Environment

- Students are limited to one studio-based course due to space limitations and should be flexible with subject choices

UNSW Business School

The following courses are not available to exchange students:

- Industrial Training courses including MARK2999, MARK3999, MARK4999, FINS3100, FINS3200
- MARK6xxx courses
- GBAT course

Faculty of Medicine & Health

- Exchange students can enrol in courses from the School of Medical Science however courses in the Doctor of Medicine program are not open to exchange students.

Faculty of Engineering

- Enrolment in Biomedical Engineering and Computer Science courses is extremely limited; students need to be prepared to select courses from another major.

Faculty of Science

- Postgraduate psychology courses are not available to exchange students.
- Undergraduate psychology courses are very limited.

Courses not open for exchange

- MBA Coursework
- Courses that are part of the Honours degree (4xxx)
- UNSW Canberra at the Australian Defence Force Academy (all courses starting with 'z')
- Doctor of Medicine program

Term information and dates

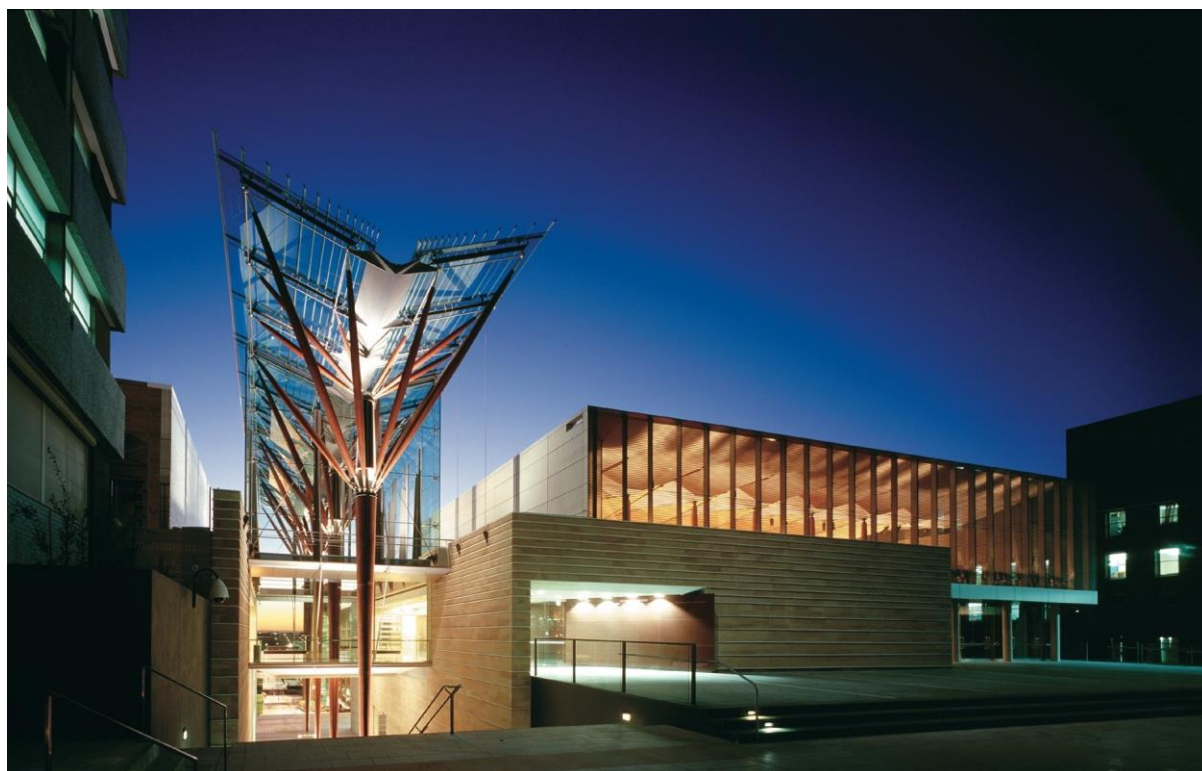

The UNSW academic calendar comprises of three terms as well as a Summer Term in January (ST) and Winter (WT) intensive term in August.

For semester-based programs, you have the choice of 3 courses over a standard Term, or 4 courses over a Double or Tailored Term. For yearlong programs, you can take 8 courses. Please note the course sequence below.

At the point of nomination, your home university needs to enter a [term selection](#) for you. This determines your length of study and terms you will be at UNSW. Please discuss your term options with your home university.

Term Options

Three courses (18 UNSW credits, 22.5 ECTS)

If you would like to study 3 courses, you can choose from:

- Term 1 (T1) which is from February to mid-May and has a course sequence of 3
- Term 3 (T3) which is from September to mid-December and has a course sequence of 3

Four courses (24 UNSW credits, 30 ECTS)

If you would like to study 4 courses, you can choose from:

- Tailored Term 1 (ST +T1) which is from January to mid-May and has a course sequence of 1+3
- Tailored Term 3 (WT + T3) which is from August to mid-December and has a course sequence of 1+3
- Term 1 + Term 2 (T1+T2) which is from February to late August and has a course sequence of 2+2
- Term 3 + Summer Term (T3+ST) which is from September to early February of following year and has a course sequence of 3+1

Six courses (36 UNSW credits, 45 ECTS)

If you would like to study 6 courses, you can choose:

- Term 3 + Term 1 (T3+T1) which is from September to mid-May of following year and has a course sequence of 3+3

Eight courses (48 UNSW credits, 60 ECTS)

If you would like to study 8 courses or one year, you can choose:

- Term 1 + Term 2 + Term 3 (T1+T2+T3) which is from February to mid-December and has a course sequence of 3+2+3
- Term 3 + Term 1 + Term 2 (T3+T1+T2) which is from September to late August of following year. and has a course sequence of 3+3+2
- Tailored Term 3 and Tailored Term 1 (WT +T3 + ST + T1) which is from August to mid-May of following year and has a course sequence of 1+3+1+3

Tailored Term 1 or Tailored Term 3

Course Sequence - 1 + 3

Maximum number of courses - 4

Maximum units of credit - 24

Term 1 or Term 3

Course Sequence - 3

Maximum number of courses - 3

Maximum units of credit - 18

Term 1 + Term 2

Course Sequence - 2 + 2

Maximum number of courses - 4

Maximum units of credit - 24

Term 3 + Summer Term

Course Sequence - 3 + 1

Maximum number of courses - 4

Maximum units of credit - 24

Term 3 + Term 1

Course Sequence - 3 + 3

Maximum number of courses - 6

Maximum units of credit - 36

Full Year - commencing Term 1 or commencing Term 3

Course Sequence - 3 + 2 + 3 or 3 + 3 + 2

Maximum number of courses - 8

Maximum units of credit - 48

Tailored Term 3 and Tailored Term 1

Course Sequence - 1 + 3 + 1 + 3

Maximum number of courses - 8

Maximum units of credit - 48

Term dates

Please refer to the [Academic Calendar for Study Abroad and Exchange](#) and [Key dates](#) for UNSW term dates and important information. It is important you are aware of your start and end dates.

You are required to study with UNSW for the entire session and exam period. Your personal exam timetable will be released mid term and you should not make travel arrangements until you have received your exam timetable.

Orientation

All Exchange students are required to attend an in-person compulsory orientation according to their start term. It is normally held the week before Term starts. Details are confirmed closer to the time.

2024 International Student Welcome

- Summer Term: 2 January
- Term 1: 5 February
- Winter Term: 8 August
- Term 3: 2 September (TBC)

2025 International Student Welcome

- Summer Term: 9 January (TBC)
- Term 1: 3 February (TBC)
- Winter Term: TBC
- Term 3: TBC

Applications



How to apply

Our application is completely online. You first need to be nominated by your home university (please do not make a direct application through our website). Nomination information will be emailed to your home university separately.

Once nominated, an email is sent to you with information on how to submit your application. Please check the terms you have been nominated for as changes cannot be made after applications are submitted. You also need to upload the following supporting documents as part of your application by the application deadline. We do not require hard copies of applications. We send offers and enrolment information after the application deadline.

1. Academic transcript (with English translation, if applicable)
2. ID page of a valid passport. (Please make sure you have a valid passport at time of application)
3. Proof of [English language](#) proficiency, if applicable.

Deadlines

Tailored Term 1 & Term 1

- Nomination deadline: 5 October
- Application deadline: 15 October

Tailored Term 3 & Term 3

- Nomination deadline: 26 March
- Application deadline: 1 April

All dates are Sydney time (AEDT). We send offers and visa documentation after the application deadline. It is not possible to change your term selection once your application has been submitted.

Language requirements

UNSW recognizes [these countries](#) as English-speaking. If you do not hold a passport for one of the countries as listed, you need to provide proof of your English proficiency by the application deadline. You can do this by providing evidence that you meet one of [UNSW's approved criteria](#). English proficiency is an entry requirement, and we cannot accept students into the Exchange Program without it. Proof of English that does not meet one of the [UNSW's approved criteria](#) cannot be accepted.

It is important to check you meet our English requirements before being nominated by your home university. It is too late to sit a test after our application deadline if you don't meet our entry requirements. You should arrange your language tests at least 6 months in advance.

English Language Test Scores

UNSW accepts English language test scores of 6.5 IELTS or 90 TOEFL (iBT) for Exchange students. Exchange students are only required to meet the overall score for IELTS and TOEFL, you do not need to meet each of the subtests. You must have completed the test no more than two years before your intended start date at UNSW, the English test must be dated on or after the 1st of January (two years prior) for Summer Term and Term 1 commencement or the 1st of August (two years prior) for Winter Term and Term 3 commencement.

Post-Secondary or Tertiary Qualifications in English

If you have successfully completed at least **one consecutive year of full-time** study at a Bachelor level or higher where the sole language of instruction and assessment was English, you are not required to undertake a language test if you can provide a statement or certificate from your home university confirming this. The study must have been completed no more than **two years** prior to the commencement of your Exchange at UNSW.

Senior Secondary Qualifications

UNSW recognizes some [academic qualifications](#) completed in non-English speaking countries. All qualifications must have been undertaken no more than **two years** prior to the year of commencement of study at UNSW except for qualifications from Denmark, Germany, Sweden or Norway, which must be undertaken no more than **ten years** prior to the year of commencement of study at UNSW.

For Other acceptable criteria please see [English language requirements | UNSW Sydney](#)

The Australian Government also has requirements for student visas. You must verify and meet any visa requirements.

[Grade requirements](#)

You should have equivalent to either a credit average or 3.0 GPA

Housing, living costs & Student Life



On-campus Housing

UNSW [affiliated Colleges and Apartments](#) provide high quality accommodation, and you should apply directly to the College or Apartment as early as possible. Please make sure you select the affiliated options when using the above link. On campus accommodation is extremely limited and is not guaranteed even if you apply by the deadline.

Off-campus Housing

Most exchange students choose to live off campus and enjoy the beautiful suburbs that surround UNSW. Sydney is a safe city, with public transport connecting the UNSW campuses, beaches, and city centre.

- [Resources and advice](#)
- We recommend students arrive 1-2 weeks early to find off campus accommodation. You may wish to [book temporary accommodation](#) to allow time to find more permanent housing.
- Off campus accommodation is not endorsed by UNSW and you should take all precautions to secure safe housing, [learn about your rights as a tenant](#).

You should never arrange off-campus accommodation or transfer money from overseas.

Student Accommodation Providers

Sydney has several accommodation providers catering specially to students. These providers are located around Sydney – generally around 20-50 minutes by public transport from the UNSW campus. These options offer high-quality rooms with extra services and Facilities. Options include [JGLU](#) and [Scape](#)

Approximate living costs

We recommend around AU\$10,000 – AU\$12,000 per half year and AU\$19,000 – AU\$23,000 per year for an in-person exchange. Please note that this is for the [basics](#) and does not include holiday travel and entertainment costs.

You may also wish to refer to the Study Australia [Cost of Living Calculator \(studyaustralia.gov.au\)](#) to get an estimate on how much it could cost to have the lifestyle you choose in Australia.

Unless you are contacted with confirmation of a scholarship from UNSW, there are no other available funding opportunities. Students are responsible for funding their own exchange.

Student Life

There is always a lot's happening at UNSW and we encourage you to get involved in UNSW student life. [Find out more!](#)

Insurance & OSHC



Overseas Student Health Cover

An Australian student visa requires you to have [Overseas Student Health Cover](#) (OSHC) for its full duration (most students from Belgium, Norway and Sweden are exempt). OSHC is a government requirement and cannot be waived with off-shore health insurance and/or comprehensive travel insurance.

The UNSW's preferred provider is Medibank. Further instructions are provided upon acceptance.

Working

Student visas allow you to work once you have commenced your course at UNSW. You can work up to 40 hours a fortnight during session and unlimited hours when your course is not in session.

[UNSW Employability](#) can assist you with your resume and interview preparation.

Transcripts



UNSW transcripts

An official transcript will be sent to you digitally through [My eQuals](#) at the end of your exchange, after results are released, that you can share with your home institution.

See [Grade Definitions](#) and [Comparing grading systems](#) for details on our grading system.

Transcripts for UNSW students

For Exchange Partners who send transcripts for UNSW students electronically, please send them to toc@unsw.edu.au

Contact details



Useful websites

UNSW Sydney [unsw.edu.au](https://www.unsw.edu.au)

Academic calendar student.unsw.edu.au/calendar

Courses handbook.unsw.edu.au

UNSW Course Outlines <https://www.unsw.edu.au/course-outlines>

Key Dates student.unsw.edu.au/calendar/exchange/inbound

Faculties unsw.edu.au/faculties

Housing accommodation.unsw.edu.au and student.unsw.edu.au/accommodation

Equitable Learning Services <https://student.unsw.edu.au/els>

Exchange Office

Email: exchange@unsw.edu.au

Visit us on the web at www.unsw.edu.au or [Study Abroad and Exchange at UNSW](#)

Exchange Team

Anna - Lead, Learning Abroad Exchange

Elena - Manager, Learning Abroad Exchange

Philippa - Program Officer for Asia, UK & Ireland, Israel, New Zealand and South Africa

Emily - Program Officer for USA, Canada and Latin America

Daniel - Exchange Advisor for Europe

UNSW Security

For after hours emergencies please contact UNSW security on

General Security

P : +61 2 9385 6000

Campus Emergency

P : +61 2 9385 6666

W: www.estate.unsw.edu.au/security/your-safety



UNSW CRICOS Provider Code: 00098G | ABN: 57 195 873 179

DISCLAIMER:

UNSW programs, courses and any arrangements for programs and fees including staff allocated, as stated in the Factsheet or any other University publication, announcement or advice of the University, are an expression of intent only and are not to be taken as a firm offer or undertaking. The University reserves the right to make alterations to any matter contained within this publication without notice. Information in this Factsheet is accurate as of June 2023, but may be amended without notice by the University. All costs and fees are provided in Australian Dollars (AUD\$). Any agreement with the University does not remove the right to take action under Australia's consumer protection laws.

COMPLIANCE:

The Education Services for Overseas Students (ESOS) Act 2000 sets out the legal framework governing delivery of education to overseas students studying in Australia on a student visa. UNSW in providing education services to overseas students complies with the ESOS Framework and the National Code of Practice for Registration Authorities and Providers of Education and Training to Overseas Students 2018 (The National Code). A description of the ESOS framework can be found at the following link: internationaleducation.gov.au/Regulatory-Information/Pages/regulatoryinformation.asp